

Series 400 Specifications and Dimensions

STANDARD FEATURES:

- 1-1/2 through 200 HP.
- 230/460 volt, 60 Hz., three phase, explosion proof motors (see below for starters and controls).
- Standard, single-stage, Rotor/Stator supplied with either disintegrating, slotted, square hole or fine screen stator head.
- Equipped with a cartridge type single mechanical seal.
- Type 316 stainless steel wetted parts.
- NPT threaded connections on units through 10 HP. Larger units use standard ANSI flanges.
- All non-stainless steel external surfaces coated with a white two part epoxy paint.

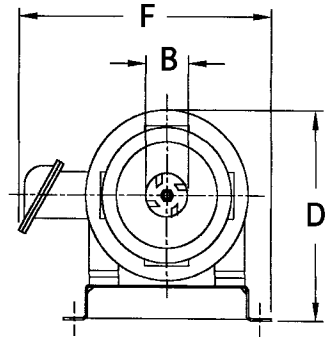
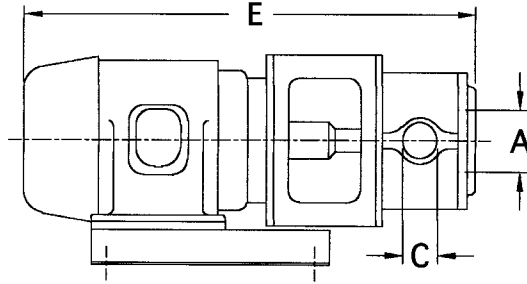

**Series 400 Direct-Driven
(Models 401-425)**

AVAILABLE OPTIONS:

- Dual stage design Rotor/Stators to increase shear rate per pass.
- Special motors including inverter duty, wash-down and stainless steel as well as special voltages and frequencies.
- Special single and double mechanical seals.
- Sanitary designs with special seals, polished components and sanitary connections.
- Jacketed mixing chamber for heating or cooling.
- Portable carts mounted on casters in either carbon or stainless steel.
- Vertical designs available through 10 HP.
- Skid mounted recirculating systems including vessel, piping and valves.
- Controls such as inverters, motor starters, or explosion proof operators stations are available (voltage, frequency and type of enclosure must be specified).
- Specially designed 400 series units can be equipped with the SLIM System for incorporating powders directly into the high shear zone.

**Series 400
Belt-Driven
(Models
430-4100)**

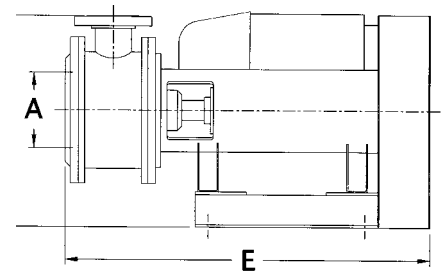
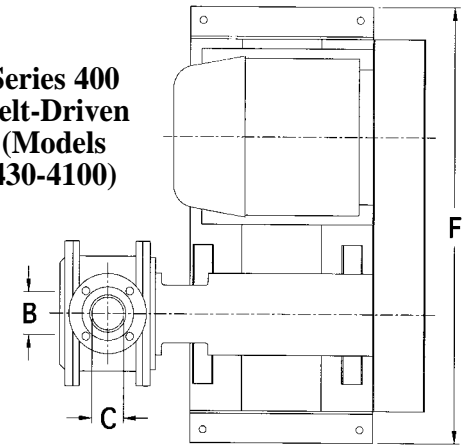

Series 400	STD HP	A Rotor Dia.		B Inlet Size		C Outlet Size		D O.A. Height		E O.A. Length		F O.A. Width		Weight		Capacity Water	
		"	mm	"	mm	"	mm	"	mm	"	mm	"	mm	Lbs.	Kgs.	GPM	L/Min.
401	1.5	2 1/2	64	1 1/2	38	1	25	13 1/2	343	23 7/8	616	13 15/16	354	90	41	66	250
405	5	3.5	89	2	51	1 1/2	38	13 1/2	343	27 1/2	699	14 1/4	362	160	73	180	680
410	10	4	102	2 1/2	64	2	51	13 1/2	343	31	787	16 15/16	430	370	168	240	908
425	25	4.5	114	3	76	2 1/2	64	19 3/4	484	36 5/8	897	40 1/2	992	790	351	350	1325
430	30	7	178	4	102	3	76	19 3/4	484	36 5/8	897	40 1/2	992	985	438	600	2271
450	50	11	279	5	127	4	102	27 1/2	674	45	1102	54 1/2	1335	1410	627	910	3444
475	75	12.5	318	6	152	5	127	27 1/2	674	45	1102	57	1397	1940	862	1490	5640
4100	100	13	330	8	203	6	152	27 1/2	674	45	1102	59	1446	2290	1018	1785	6756

HSM 400 SS-00



CHARLES ROSS & SON COMPANY

P.O. Box 12308, 710 Old Willets Path, Hauppauge, NY 11788 • Fax: 1-631-234-0691 • Tel: 1-631-234-0500

Website: www.mixers.com • Email: sales@mixers.com